



**MBED**®

# For Built-Up and Modified Bitumen Roofing

## PRODUCT DATA SPECIFICATIONS

### PRODUCT DESCRIPTION

MBED is a simple solution to a long standing roofing challenge; creating a reliable joint between two seemingly incompatible materials (metal & roofing). The MBED system uses a continuous pattern of offset holes in the flange through which two layers of roofing plies can bond together, sandwiching the metal flange between them. Edge and membrane become one to create an impregnable barrier against wind and water.

### FEATURES & BENEFITS

- Roofing plies bond together through metal flange to create exceptional seal.
- Available in two styles:
  - Gravel stop for gravel surfaced roofs.
  - Water or Box style for modified bitumen roof materials.
- Quick and easy installation saves labor.
- Comes with a 20-Year, 110 mph, excel warranty.
- ANSI/SPRI/FM-4435 ES-1 approved.



*MBED Style B*

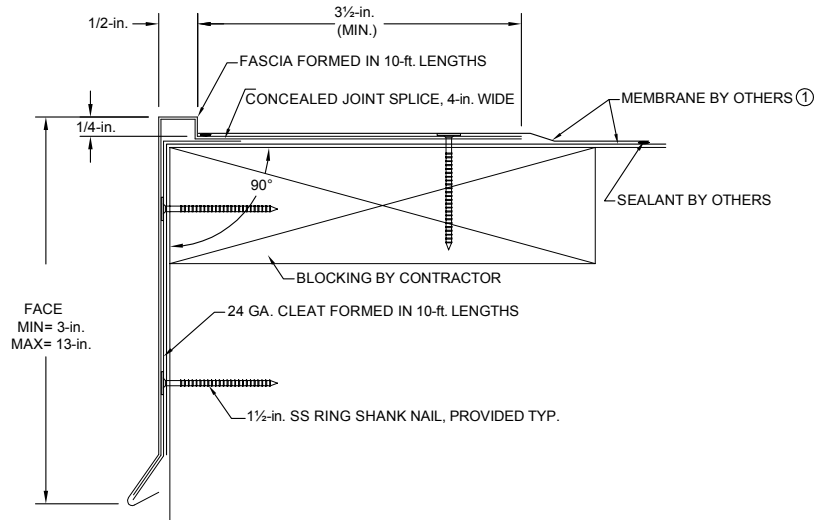

① Coordinate installation with membrane manufacturer.

*MBED Style B*

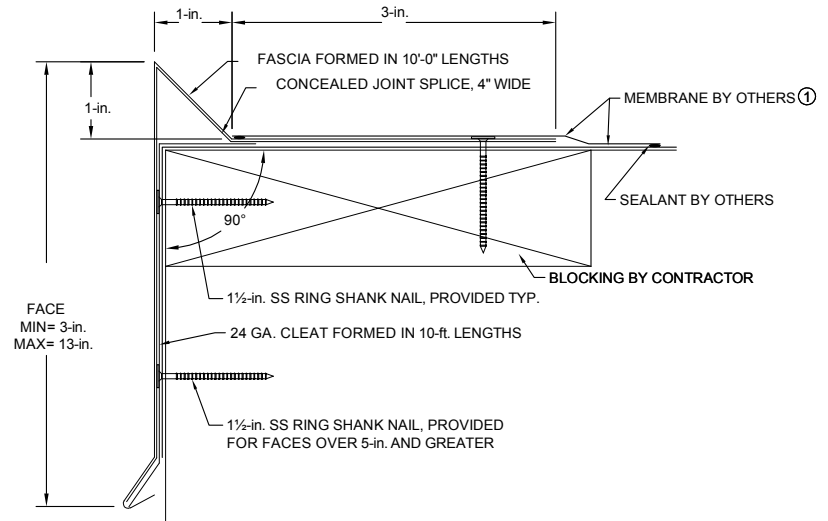

① Coordinate installation with membrane manufacturer.

*MBED Style G*



**EdgeSystems**



**MBED**®

# For Built-Up and Modified Bitumen Roofing



## INSTALLATION PROCEDURE

### SPECIFICATIONS *(short form)*

The roof edge system for Modified Bitumen or built-up roofing material shall be MBED.

The roof edge shall be (insert preference) formed metal fascia with a pattern of perforations through the flange and with a continuous cleat. Fascia and cleat will be in 10-ft. lengths. Finish shall be (insert preference).

### DESCRIPTION

MBED is a two-part assembly designed for Modified Bitumen or BUR roofs. The system consists of a continuous cleat and an exterior fascia. The holes create an open area of more than 60%, which allow the cap sheet to bond through the holes directly to the base sheet below. The standard exterior fascia is formed from .040-in., .050-in. aluminum and 22 Ga. and 24 Ga. galvanized steel. Other metals may be available by request.

### INSTALLATION PROCEDURES

*This is a general outline only. Please refer to our full installation guide for additional specific detail.*

#### Preparation:

Wood perimeter nailing plates must be straight and securely anchored to the deck or wall. Install roofing base sheet per membrane manufacturer's instructions. Install continuous cleat nailing through face with minimum 1½-in. galvanized roofing nails. Hook the fascia drip onto the cleat. Rotate fascia back so face is flush to wall. Insert joint splice plate(s). Leave a ¼-in. gap at each joint for thermal movement. Nail roof flange through pre-punched fastener holes using 1½-in. roofing nails.

Apply roofing cap sheet. Always coordinate with the membrane manufacturer before starting installation.

### FINISHES

- Natural mill aluminum, stainless steel or copper
- Pre-coat Kynar 500® — from the manufacturer's standard color chart
- Post-coat Kynar 500 — industry Non-standard Kynar 500 - colors requiring multiple coats or protective clear coats

### GUARANTEE

A. Manufacturer's Standard Warranty: Warranted materials shall be free of defects in material and workmanship for five years after shipment. If, after inspection, the manufacturer agrees that materials are defective, the manufacturer shall at their option repair or replace them. For decorative finish warranty, consult manufacturer.

B. Special Performance/20-Year Excel Warranty: Manufacturer shall guarantee that a standard size roof edge system, when installed per manufacturer's instructions, will not blow off, leak, or cause membrane failure, in wind conditions up to 110 mph, or the manufacturer shall at their option repair or replace them.

C. Decorative Finish Warranty: *(consult Manufacturer).*

### QUALITY ASSURANCE

The fascia product shall be listed in the current Factory Mutual Research Corporation Approval Guide using SPRI Test Method RE-2 Pull-Off test for fascia. Fascia shall be certified to design pressures as indicated in current edition of Wind Resistance Standard for Edge Systems Used with Low Slope Roofing Systems.

### TECHNICAL SERVICES

Shop drawings are available from the factory. Product samples, detail sheets, color chips and color charts are ready for your submittal package. Long form specifications and CAD details are available on our website. For personal assistance with questions or submittals, contact your local representative or contact your OMG local representative.



**EdgeSystems**

Superior productivity.  
Superior performance.

4 COMMERCE WAY, ARDEN, NC 28704 USA  
800-892-9173 828-676-1700 OMGEDGESYSTEMS.COM

Copyright © 2017 OMG, Inc. All rights reserved.

